

Technical passport

Multifunctional sports complex

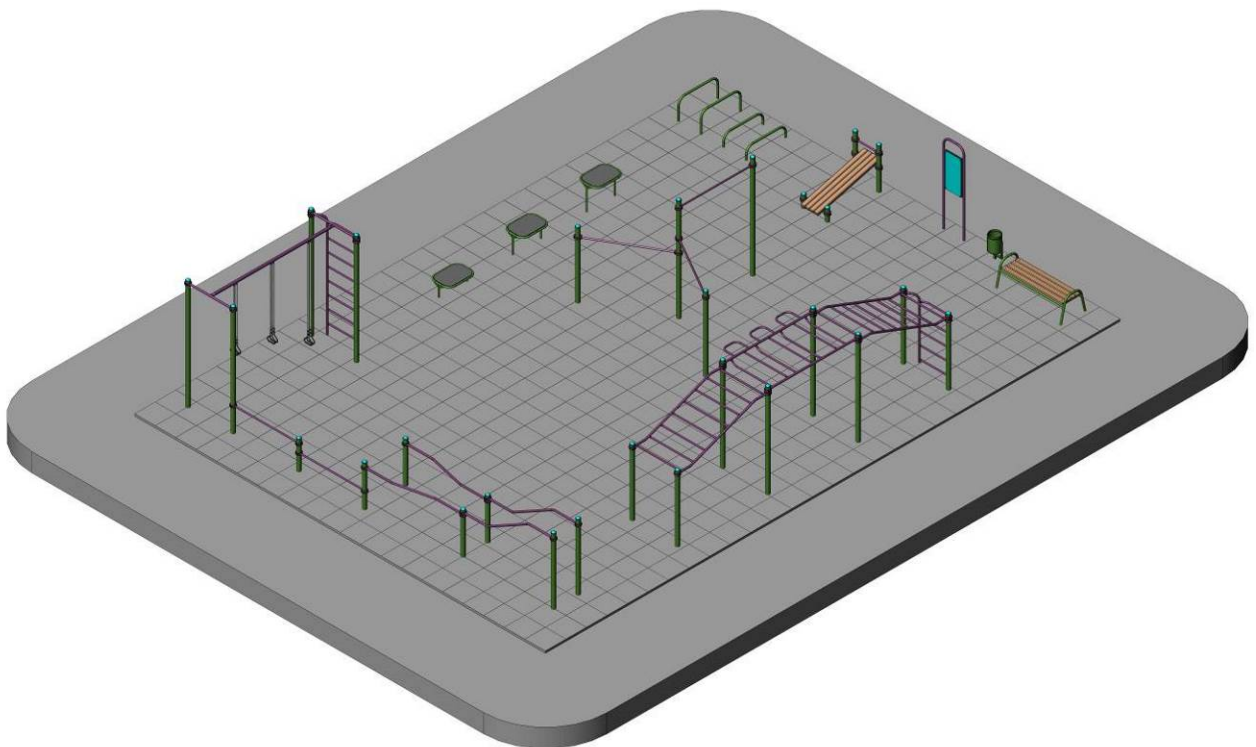

1. GENERAL INFORMATION

Purpose and content of this document. This document contains a general description of the equipment, information on installation, intended use, maintenance, current repair and manufacturer's warranty.

Distribution of this document for product modifications. The manufacturer can make changes to the design of the product, aimed at improving its characteristics, changing the design, etc. This document may not contain a description of such changes, but applies to such modified products.

2. MAIN TECHNICAL DATA AND CHARACTERISTICS

№ p/n	Product code	Name	Dimensions			Weight, kg
			Length, mm	Width, mm	Height ¹ , mm	
1	S832.6-UA	3-beams horizontal bar	2839	3261	2520	107
2	S833.3-UA	Monkey bar	6976	1500	2301	312
3	S836.2-UA	Bars TRX complex	8829	3377	2700	344
4	MF1.3-300-UA	Jumping platform (0,3 m)	718	518	300	19,2
5	MF1.3-450-UA	Jumping platform (0,45 m)	718	518	450	19,8
6	MF1.3-600-UA	Jumping platform (0,6 m)	718	518	600	20,4
7	SL100-UA	Informational stand	536	61	1963	27
8	S835.4-30	Bench inclined 1,6 m (15 degrees)	1556	724	1021	76,1
9	S834.7-300-UA	Minibars 0,3 m	1000	592	800	14
10	S834.7-500-UA	Minibars 0,5 m	1000	592	1000	17
11	S722.1	Bench without backrest (42 mm)	1603	638	553	37
12	S742	Bin 15 litres	350	250	475	9
Age range, years			from 12			
Weight limits, kg			to 130			

Jumping platform (0,3 m)
Jumping platform (0,45 m)
Jumping platform (0,6 m)

MF1.3-300-UA
MF1.3-450-UA
MF1.3-600-UA



Bench without backrest (42 mm)

S722.1





Monkey bar

S833.3-UA



Bench inclined 1,6 m (15 degrees)

S835.4-30

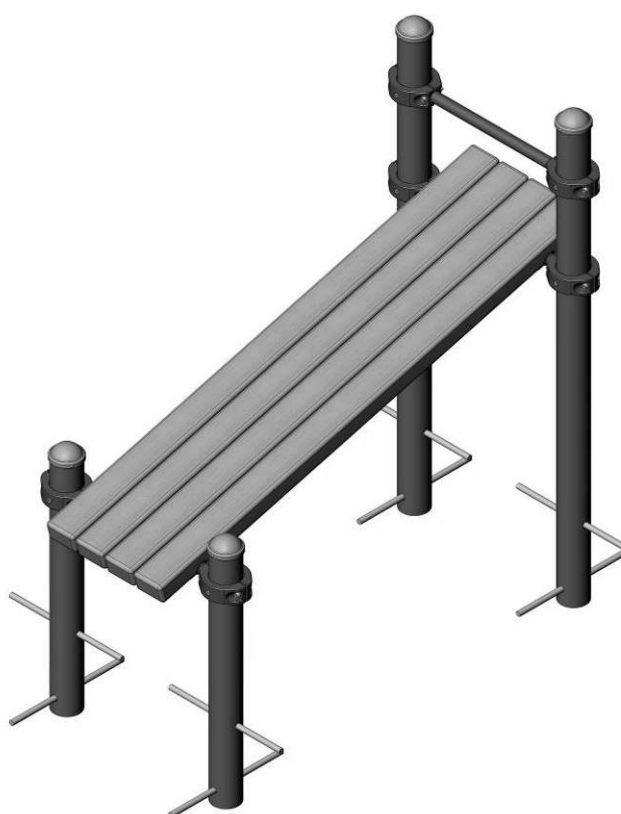

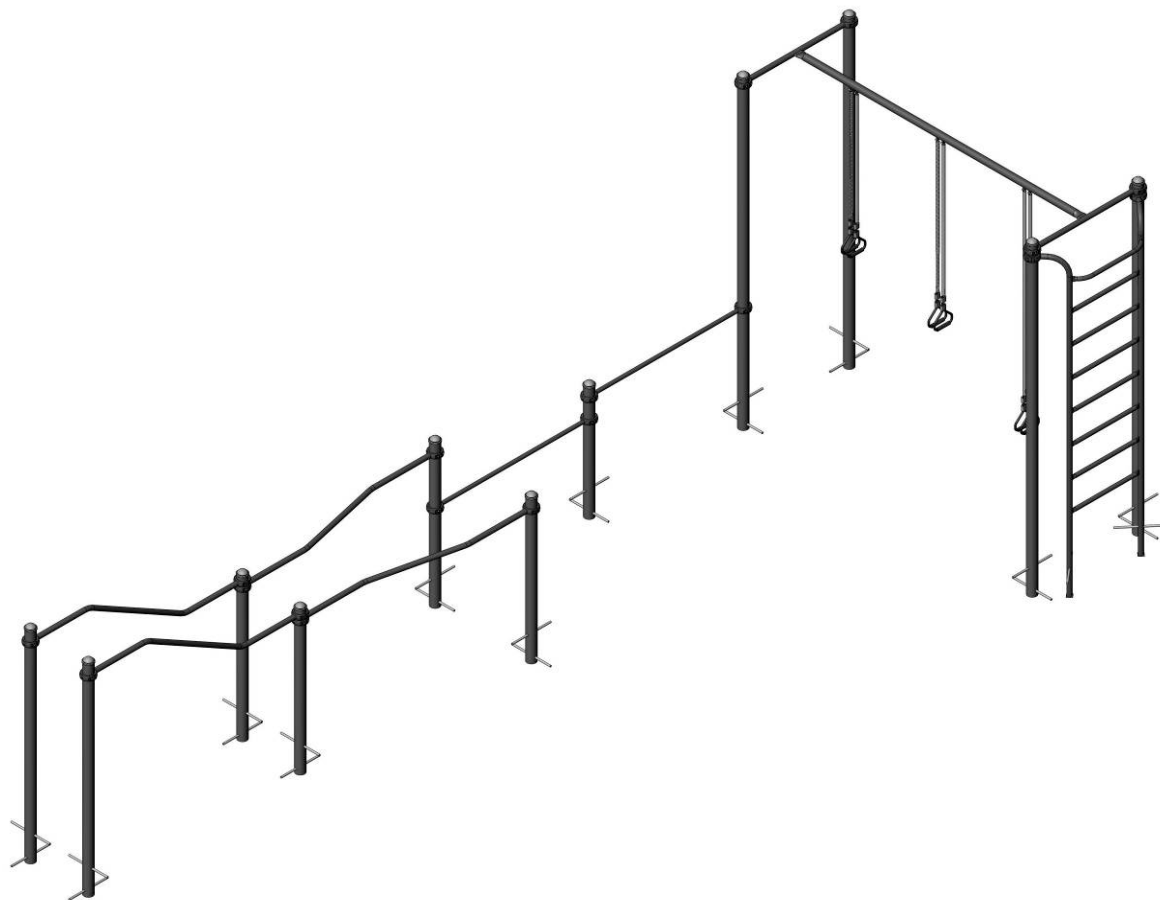

Minibars 0,5 m
Minibars 0,3 m

S834.7-500-UA
S834.7-300-UA

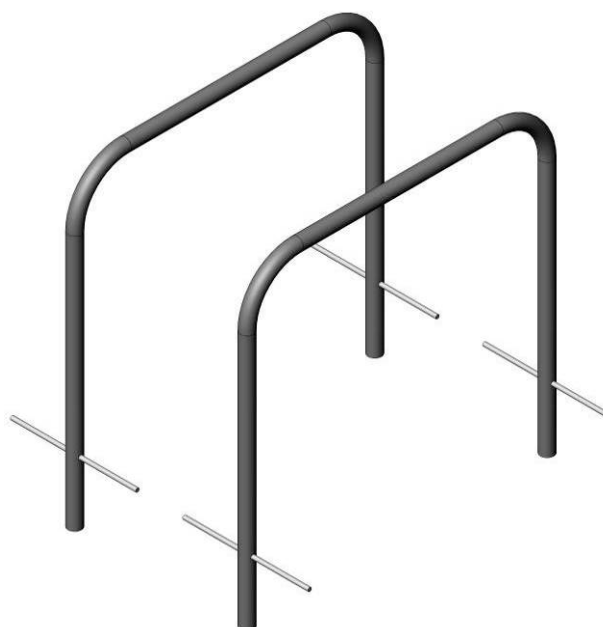

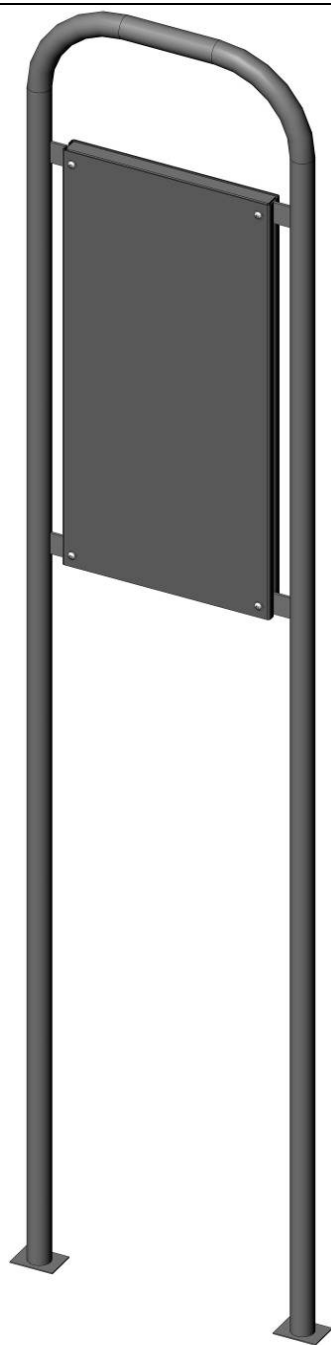

3. COMPLETENESS AND CHARACTERISTICS OF THE MAIN PARTS OF THE PRODUCT

Completeness and characteristics of the main parts of the product look at Appendix A.

4. PRODUCT ASSEMBLY AND INSTALLATION PROCEDURE

Tools and accessories. The product does not include the tools required for assembly and installation.

Product assembly and installation procedure.

3-beams horizontal bar

S832.6-UA

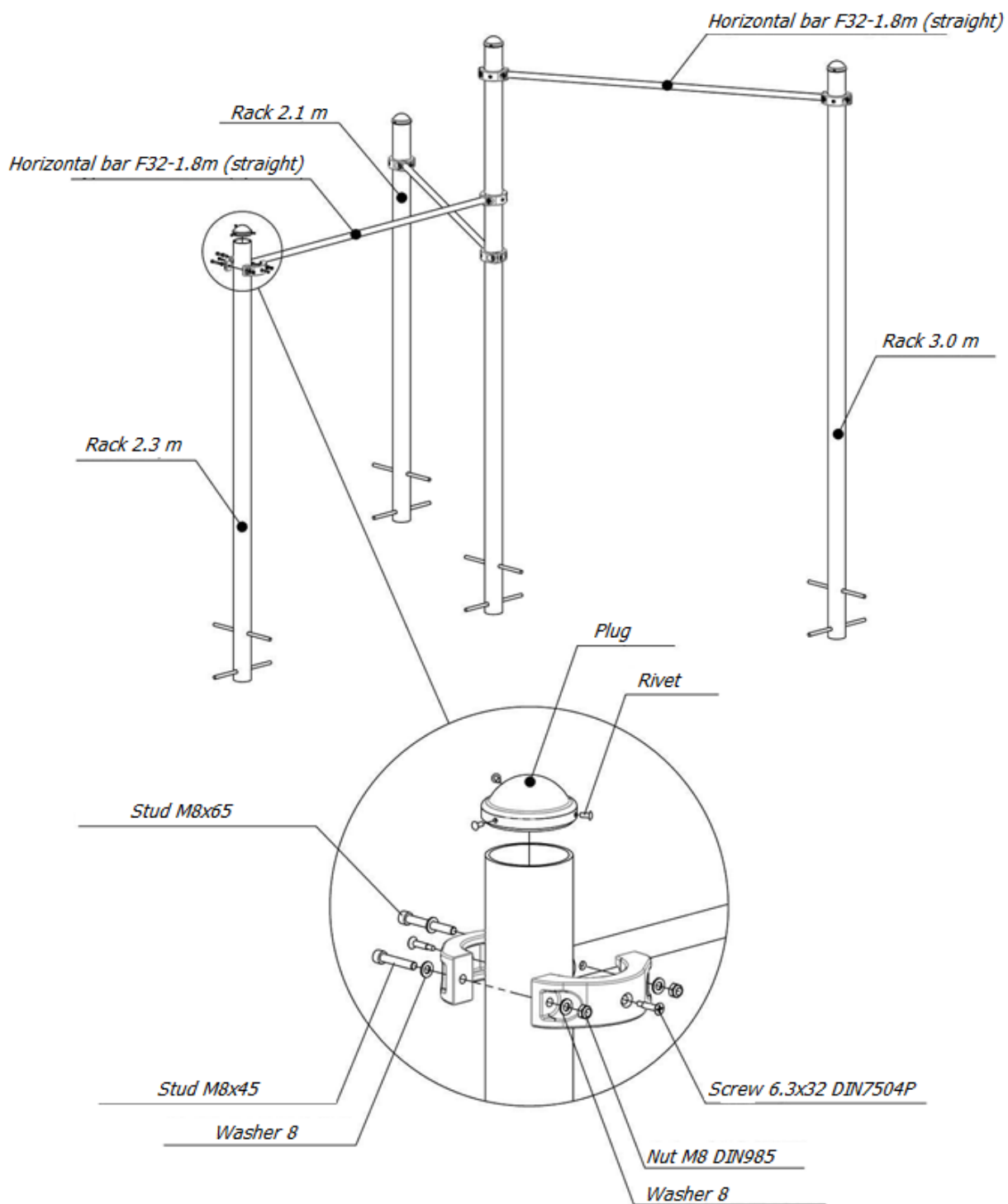

(The clamp fastening scheme is identical for the complexes S833.3-UA, S836.2-UA)

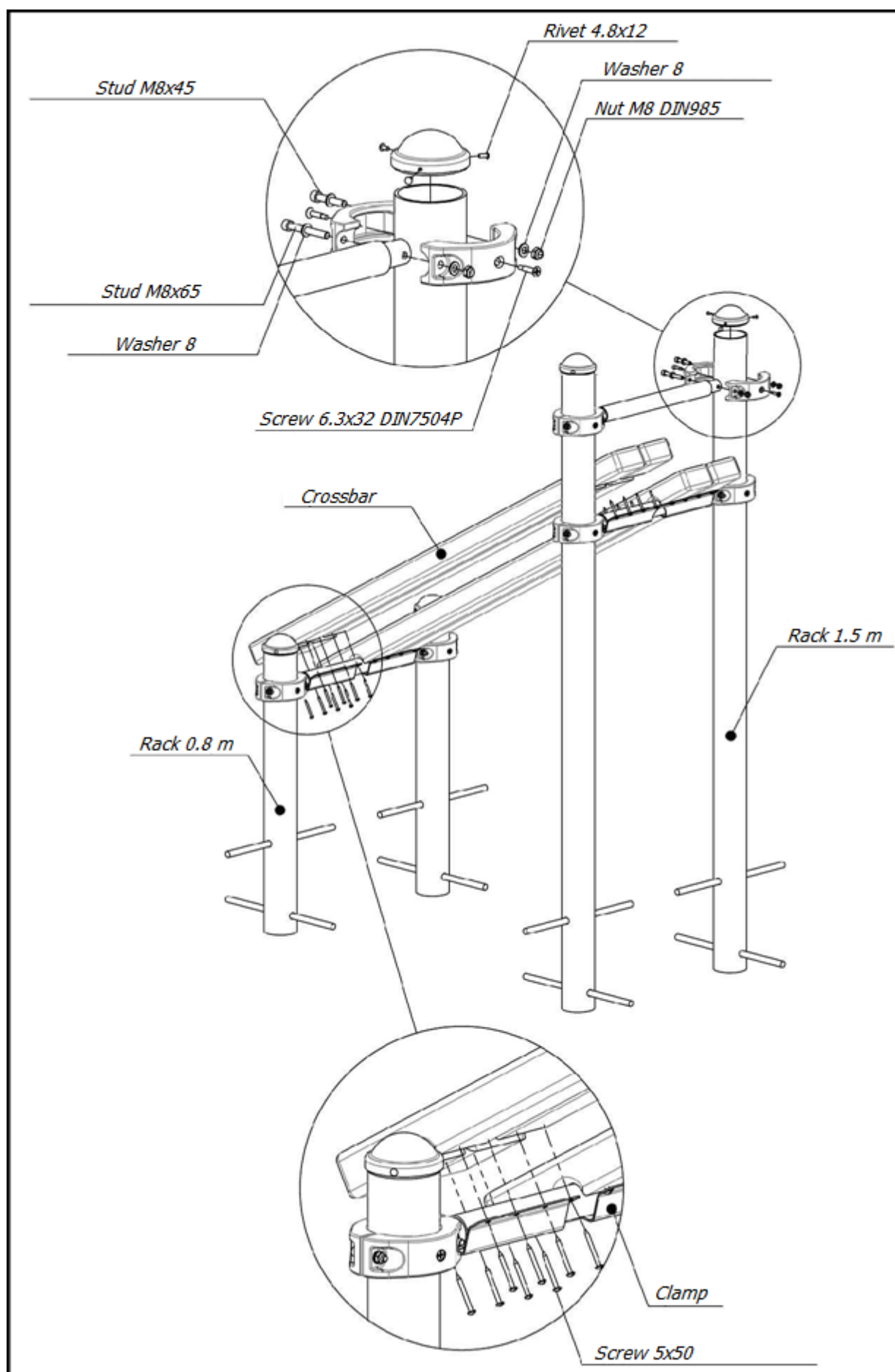

5. INSTALLATION SCHEME OF THE PRODUCT

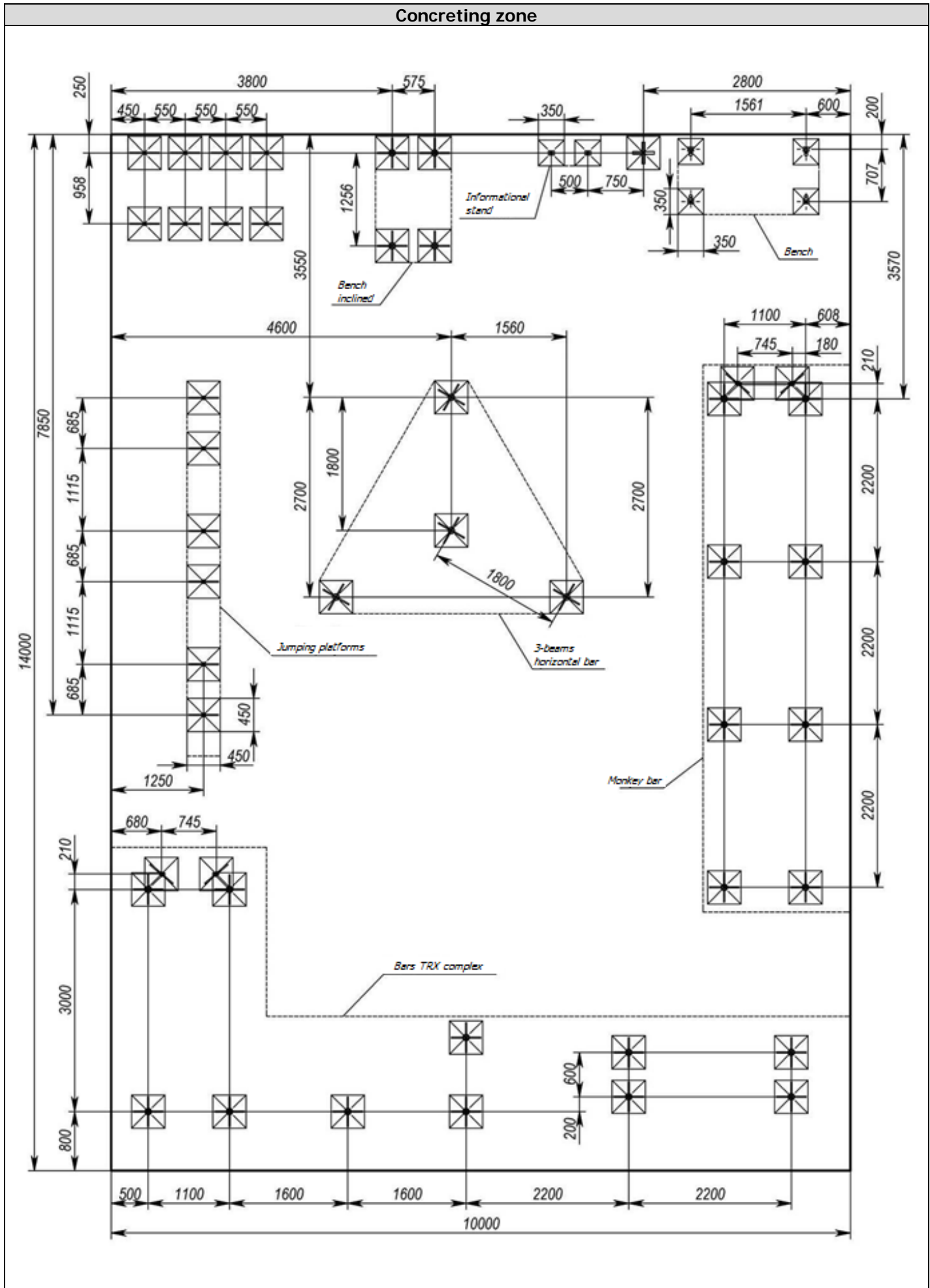

Landing zone	
Jumping platform (0,3 m) Jumping platform (0,45 m) Jumping platform (0,6 m)	MF1.3-300-UA MF1.3-450-UA MF1.3-600-UA

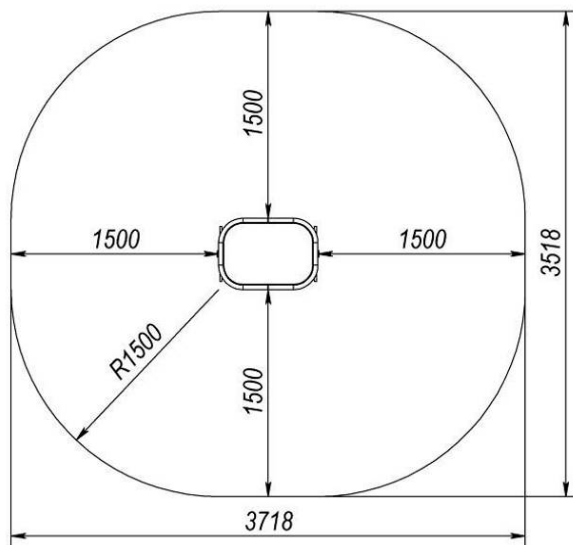

3-beams horizontal bar	S832.6-UA
-------------------------------	------------------

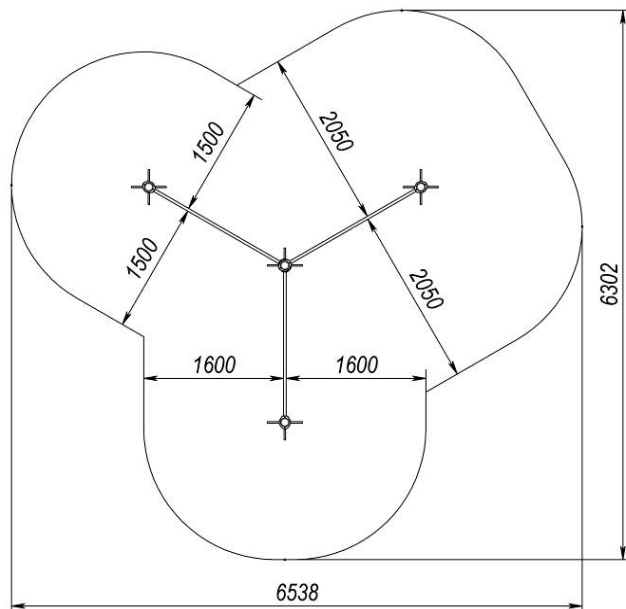

Monkey bar	S833.3-UA
-------------------	------------------

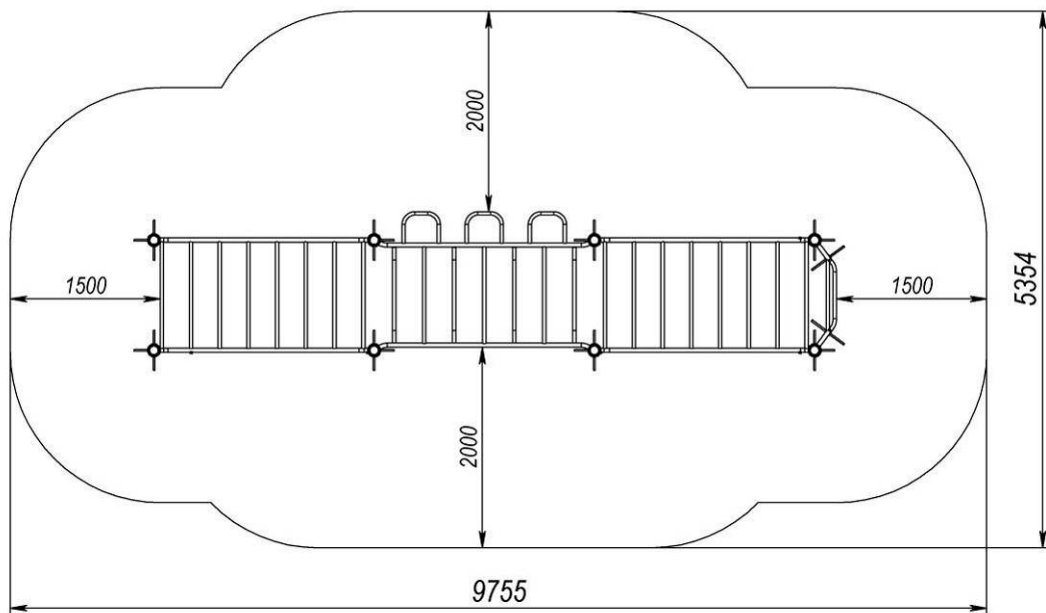

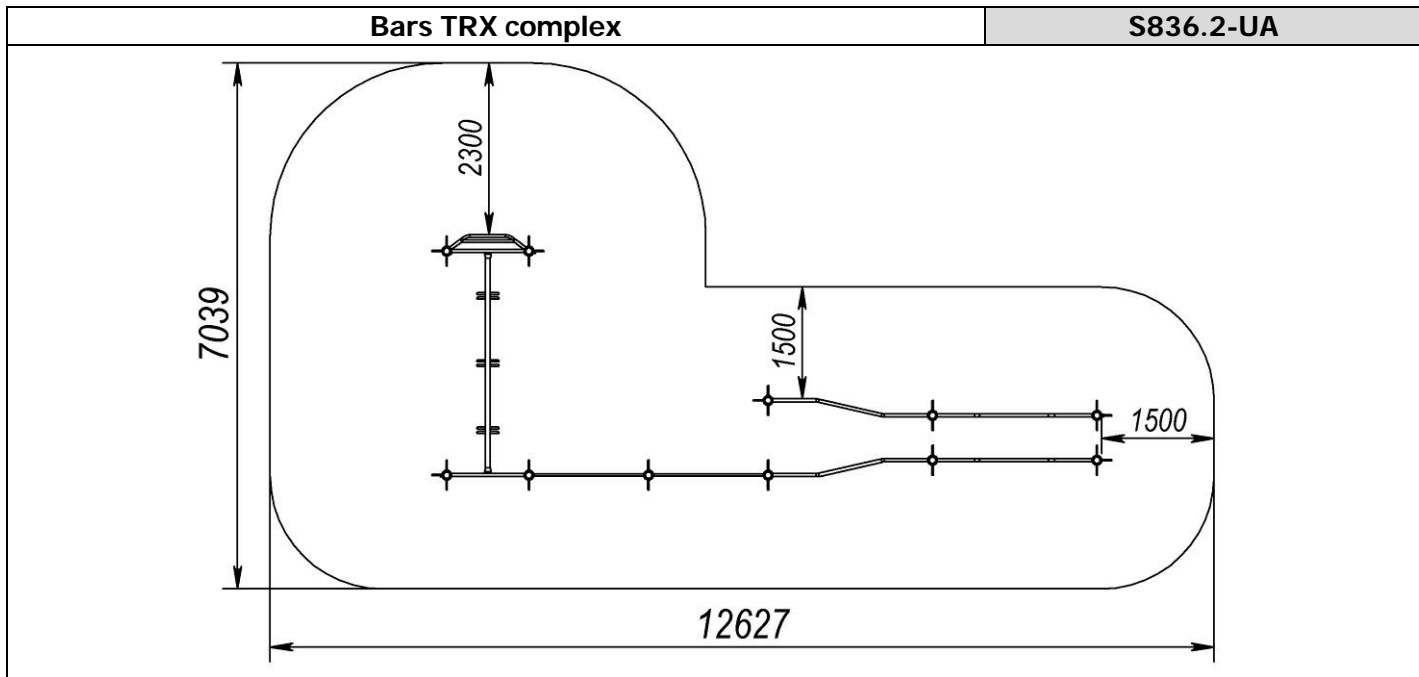

6. PRODUCT USE

Do not use the product until it has been fully and completely installed.

The product must not be used by users of a different age category.

The product must not be used by users of a different weight category.

Before using the product, clear the safety area of any unnecessary objects that may cause damage to the user (debris, tools left over from assembly and installation, etc.).

Do not use the product in adverse weather conditions (ice, snow, rain, hail, strong winds, etc.), which may cause injury to the user.

7. PRODUCT MAINTENANCE

You have purchased high-quality and reliable equipment. In the process of its production, the requirements of regulatory and technical documents of Ukraine, the CIS countries and the European Union regulating the production of children's gaming equipment were taken into account. However, it should not be forgotten that when operating any technical product, certain rules and requirements must be followed. Despite the fact that our product is of high quality and reliability, this rule applies to it in full. You should be aware that the implementation of the following rules and recommendations for product maintenance is aimed at ensuring that your child, the child of your friends or acquaintances is safe and no unforeseen factors threaten his health, life.

Remember that the operation of the product is accompanied by the influence of various negative factors on it, a complete list of which cannot be predicted. Among them, an important place is occupied by natural factors and factors caused by human influence on equipment. As a rule, their action initially leads to disruptions in the appearance of the product. Thus, under the influence of factors caused by the exploitation of a person, there may be damage to the integrity of the paint coating of parts made of wood, in the form of scuffs, chips, incisions, and when exposed to parts made of metal, damage to the paint coating in the form of nicks, chips, abrasion, etc. This leads to the emergence and development of defects that can be the cause of the destruction of the product. The product is particularly dangerous if it is used for other than its intended purpose, if the permissible loads are exceeded, or if vandalism occurs, as these factors can cause irreversible changes in the structure of the material from which the product is made, leading to destruction.

The maintenance of the product implies, first of all, the responsibility of the user to comply with all recommendations provided in this document, starting with a daily inspection of the external condition of the product before operation.

Daily inspection of the product is a very important procedure. With its help, you can timely detect any changes in the appearance of the product (deformation of individual parts, deformation of the structure as a whole or part of it, damage to parts, cracks of welds, as well as the absence of fastening of parts of the product, etc.).

Before using the product, check its operability, absence of damage, dirt on the product, sharp edges, reliability of fixing the structure, absence of unnecessary objects on the surface of the site. If the product is damaged, fully or partially inoperable, or has any other defects, do not use it.

During operation it is also necessary to inspect the condition of the product periodically - the current inspection. It includes an external inspection of the product, checking its operability (in the presence of moving elements - the smoothness of the movement of mechanisms, compliance with operating modes, etc.). Current inspection allows you to detect malfunctions caused by the operation of equipment, climatic conditions, acts of

vandalism and other factors, until they reach a critical level and the destruction of the product. The current inspection is carried out in order to detect foreign objects that may threaten the user and lead to violations of the functioning of the product. The frequency of the current inspection is set by the owner taking into account the operating conditions. If you do not have sufficient technical knowledge and skills to conduct such inspections, we recommend you to contact the authorized specialists of the manufacturer in order to obtain advice.

Every three months, a scheduled inspection should be carried out, which primarily concerns the foundation part, load-bearing elements and connection nodes of elements (their integrity and degree of deterioration).

The main annual inspection must be carried out annually by authorised specialists of the manufacturer. During the inspection, the technical condition of the equipment shall be assessed for compliance with safety requirements. The degree of deterioration and damage to wooden elements and their ability to withstand the applied loads, damage, corrosion of metal elements and the impact of these factors on the safety of the product are determined. The inspection also helps to identify the impact of repairs, if any, on the safety of the equipment.

Based on the results of the inspection, a maintenance procedure is carried out to eliminate the identified discrepancies in the product's operation. This procedure includes assessing the condition of parts and assemblies, replacing worn parts, and restoring the integrity of protective coatings. The results of the inspections, as well as the procedures carried out as a result of the inspection and maintenance of the product must be properly documented in the Registration Journal, which is an integral part of this passport. The owner of the product must keep the acts of maintenance of the product, acts of repair work done.

8. INFORMATION ON STORAGE, TRANSPORTATION AND RECYCLING

The product is transported in the manufacturer's packaging by any means of transport that ensures its safety and protection from external factors (rain, snow, sunlight, water, high humidity, etc.).

Information about transportation

Date		Brand, state number of the car/trailer	Position, full name	Signature
Departure	Arrival			

Before installation store the product in the original packaging in dry, closed rooms with natural air ventilation.

If it is necessary to transport the product to another location after use it is recommended to use the manufacturer's packaging.

If you need to store the product for a long period of time, you must observe the following storage rules (the list of conditions is not complete):

- place the product in a closed, dry room with natural ventilation;
- protect the product from external factors (dust, water drops, etc.) with a large plastic bag, leaving space for free air circulation;
- take other measures to save the design and features of the product during storage.

Observe the following recommendations when removing the product from storage and preparing for installation:

- remove the product from the packaging material (polyethylene, cardboard, other packaging materials);
- remove dust and other contaminants from the surface of the product;
- check that the parts are complete and not damaged.

Information about storage

Date		Product storage conditions	Full name	Signature
Putting into storage	Removal from storage			

After the end of the equipment's service life, the buyer determines the procedure for its usage by himself. If you decide to recycle the equipment, please contact the seller or specialised organisations.

The equipment does not contain any harmful impurities or materials that can harm your health and is does not need special recycling.

9. CURRENT REPAIR

All current repairs are carried out only by employees of the «Inter Atletika's» service centre or specialists specially authorised by the company.

10. MANUFACTURER'S (SUPPLIER'S) WARRANTIES

Warranty obligations are valid only for products purchased from «Inter Atletika» or its official representatives. The supplier guarantees proper operation for 1 (one) calendar year from the date of sale. During the warranty period the company «Inter Atletika» is obliged to replace the product, its components and parts that have defects with new ones or to repair these parts and components. In order to agree on the type of work to be done (replacement or repair) to a defective product or its components and parts with defects, the

company «Inter Atletika» is guided by the regulations of the Law of Ukraine «On Protection of Consumer Rights». The period within which the product is replaced or repaired is also set on the basis of the requirements of the Law of Ukraine «On Protection of Consumer Rights» or by agreement between the customer and the company «Inter Atletika». The Product or its defective parts and components that have been replaced with parts and components of proper quality shall be returned to the company «Inter Atletika», if it was requested.

During the warranty period, the product may only be repaired by representatives of «Inter Atletika» or an organisation or person authorised by the manufacturer.

The Manufacturer (Supplier) does not have warranty obligations, in particular in cases of:

- the presence of abrasion of paint and protective coatings on metal and wooden parts of the product, the appear of corrosion on metal parts, the appear of cracks on wooden parts and changes in the shape of the products, and also in case of other damage and changes in the product, which arose as a result of its natural wear;
- damage to the product as a result of improper use of the product, excess the level of the maximum load or the presence of acts of vandalism;
- installation (assembling) of the product, maintenance of the product or its repair by organizations or persons to whom «Inter Atletika» did not provide such a right;
- changes in the product design or in the case of product operation together with additional equipment and devices that have not been reviewed and approved by «Inter Atletika», as well as in the case of product use for other purposes;
- failure to perform the procedures for maintenance of the item specified in chapter 7 of this document, or not providing documents confirming their conduct;
- failure to comply with other requirements and recommendations of this document or requirements provided for by the current legislation of Ukraine;
- damage to the product or its complete destruction due to natural disaster or natural phenomena.

In case of a breakdown of the product, the customer must contact the seller of the product directly with a application, which must contain photographs of the breakdown, a detailed description of the signs and causes of the breakdown, the situation in which the breakdown occurred, the place of use of the product, as well as information on the date and place of purchase of the product, the customer's passport details, place of permanent residence, and contact telephone number. The application shall be accompanied by a receipt for the purchase of the product (or other documents confirming the purchase of the product), the equipment passport, and, in accordance with the requirements of chapter 7 of this passport, documents confirming the maintenance or repair of the product.

Address of the central service centre:

08292, Ukraine, Kyiv region, Bucha, Instytutska St. 17-b, phone number: (044) 391-33-99).

Seller

Identification code according to
USREOU

WARRANTY OBLIGATIONS

(product name in accordance with the regulatory document, brand)

The seller guarantees the compliance of the product with the requirements of the specified regulatory documents, provided that the consumer complies with the rules set out in the operating documents.

Country of product manufacture

Ukraine

Item number and name

Date of product manufacture

Obligatory technical control mark

Warranty storage period up to

The warranty storage period is calculated from the date of manufacture of the product and ends on the date specified by the manufacturer.

The warranty period for the product is twelve calendar months.

During the warranty period, that should not be less than six months, the consumer has the right to free maintenance of the product and, in case of defects (deviations from the requirements of regulatory documents), to free repair or replacement of the product or refund of its value in accordance with the requirements of the Law of Ukraine "On Protection of Consumer Rights" and the Procedure for Warranty Repair (Maintenance) or Warranty Replacement of Technically Complex Household Goods, approved by Resolution of the Cabinet of Ministers of Ukraine №506 of 11 April 2002.

If the product was operated during the warranty period in violation of the rules of use or without adherence to the manufacturer's recommendations, repairs are carried out at the expense of the consumer.

The service life (expiration date) of the product is twelve calendar months. The manufacturer (supplier) guarantees the possibility of using the product for its intended purpose during the service life (provided that post-warranty maintenance or repair is carried out at the expense of the consumer), and if such period is not set - within 10 years. The service life (expiration date) of the product is terminated in case of:

- making changes and improvements to the design of the product, as well as the use of nodes, parts, components of products not provided for in regulatory documents;
- misuse for other than the intended purpose;
- damage made by consumer
- violation by the consumer of the terms and conditions of use of the product, including those set out in this document.

(full name of the responsible person of the manufacturer (seller))

(Signature)

P. S.

Seller

Identification code according to USREOU

WARRANTY CERTIFICATE

Name of the product according to the regulatory document, brand, filled in by the manufacturer (seller)

Plant number

Production date

full name of the responsible person of the manufacturer (seller), signature, P.S.

Seller

name of the company, organization, legal address

Date of sale

Price

full name of the responsible person of seller, signature, P.S.

The product is accepted for warranty service:

Name of the company performing the warranty service, legal address

Date of taking the product for warranty recording

The number by which the product was taken for warranty recording

full name of the responsible person of the executor, signature, P.S.

The warranty period has been extended to

«	»	20
year.		
«	»	20
year.		

full name of the responsible person of the executor, signature

The product has been marked down (date and number of the inventory-act of marking down the product):

New price (sum in words):

hryvnias

full name of the responsible person of the executor, signature, P.S.

Seller _____
Identification code according to USREOU _____
TEAR-OFF COUPON FOR WARRANTY REPAIRS DURING _____ **MONTHES OF WARRANTY OPERATION PERIOD** _____

Name of the product according to the regulatory document, brand, filled in by the manufacturer (seller)
Plant number _____ **Production date** _____

full name of the responsible person of manufacturer (seller), signature, P.S.
 Executor _____
 _____ name of the company, organisation, legal address

The number under which the product is registered for warranty recording:

Repairs reason	Name of the replaced component of the product, component part	Repairs date (year.month.day)	Executor's signature

full name of the responsible person of executor, signature, P.S.
 The consumer's signature confirming that the warranty repair work has been completed _____
 _____ signature _____ date

THE STUB OF THE TEAR-OFF COUPON FOR WARRANTY REPAIR DURING _____ **MONTHES OF WARRANTY PERIOD OF OPERATION** _____

Seller _____
 Date of sale _____

full name of the responsible person (seller), signature, P.S. _____

Executor _____
 _____ name of the company, organisation, legal address

Removed (year.month.day) _____

full name of the responsible person of executor, signature, P.S. _____

Seller _____
Identification code according to USREOU _____
TEAR-OFF COUPON FOR WARRANTY REPAIRS DURING _____ **MONTHES OF WARRANTY OPERATION PERIOD** _____

Name of the product according to the regulatory document, brand, filled in by the manufacturer (seller)
Plant number _____ **Production date** _____

full name of the responsible person of manufacturer (seller), signature, P.S.
 Executor _____
 _____ name of the company, organisation, legal address

The number under which the product is registered for warranty recording:

Repairs reason	Name of the replaced component of the product, component part	Repairs date (year.month.day)	Executor's signature

full name of the responsible person of executor, signature, P.S.
 The consumer's signature confirming that the warranty repair work has been completed _____
 _____ signature _____ date

THE STUB OF THE TEAR-OFF COUPON FOR WARRANTY REPAIR DURING _____ **MONTHES OF WARRANTY PERIOD OF OPERATION** _____

Seller _____
 Date of sale _____

full name of the responsible person (seller), signature, P.S. _____

Executor _____
 _____ name of the company, organisation, legal address

Removed (year.month.day) _____

full name of the responsible person of executor, signature, P.S. _____

Registration journal

(recording work of inspection, maintenance and warranty repairs)

№ p/n	Type of work (inspection, repair etc.)	Content of the completed work, name and type of replaced components and parts	Information about the conduct (title, document number)	Authorized person (full name, position, signature)	Date of conduct

Note. Additionally information about the work done to prevent fires is included.

Appendix A

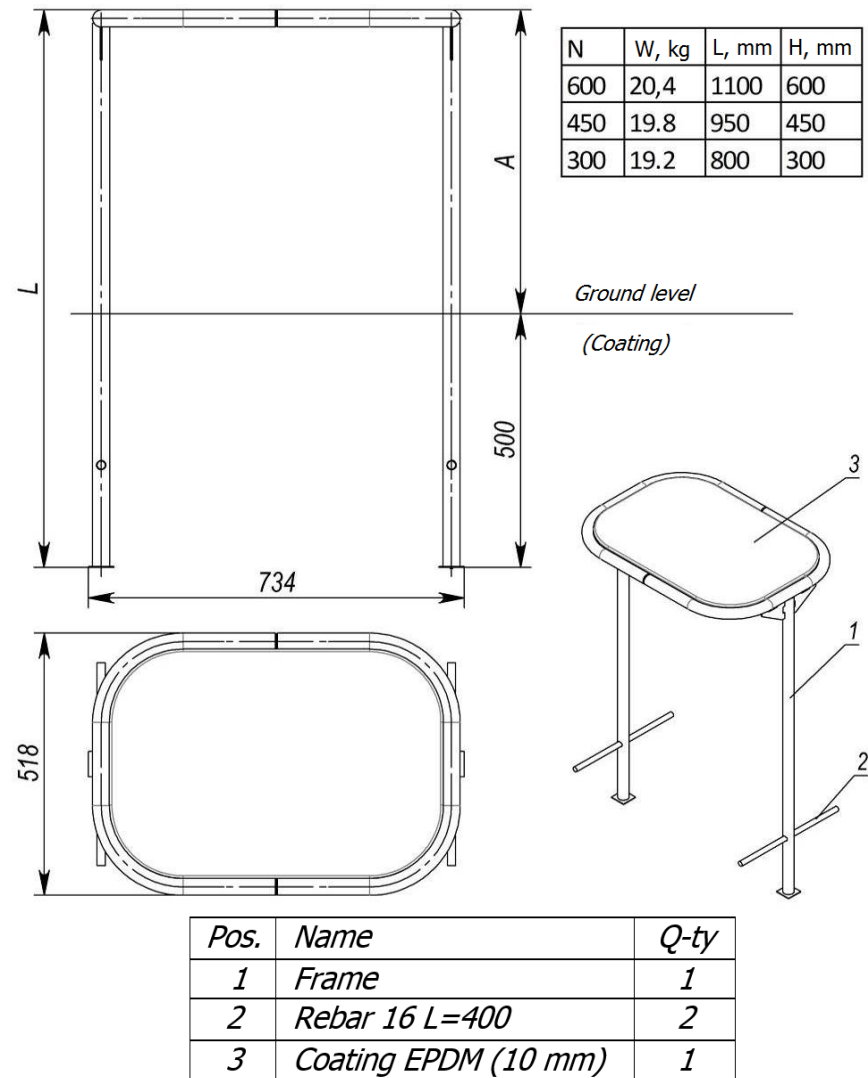

Picture 1 – for MF1.3-300-UA, MF1.3-450-UA, MF1.3-600-UA

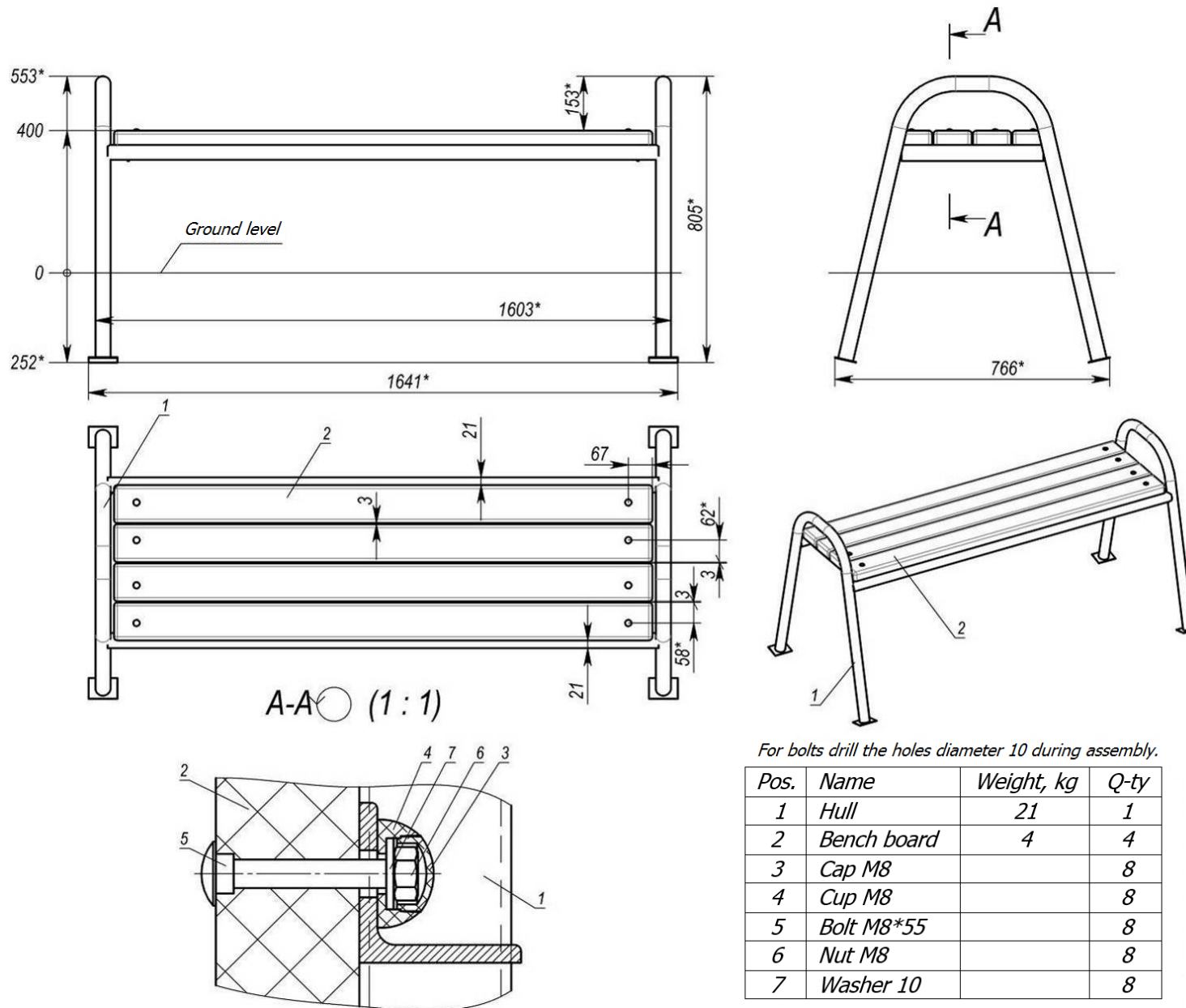

Picture 2 – for S722.1

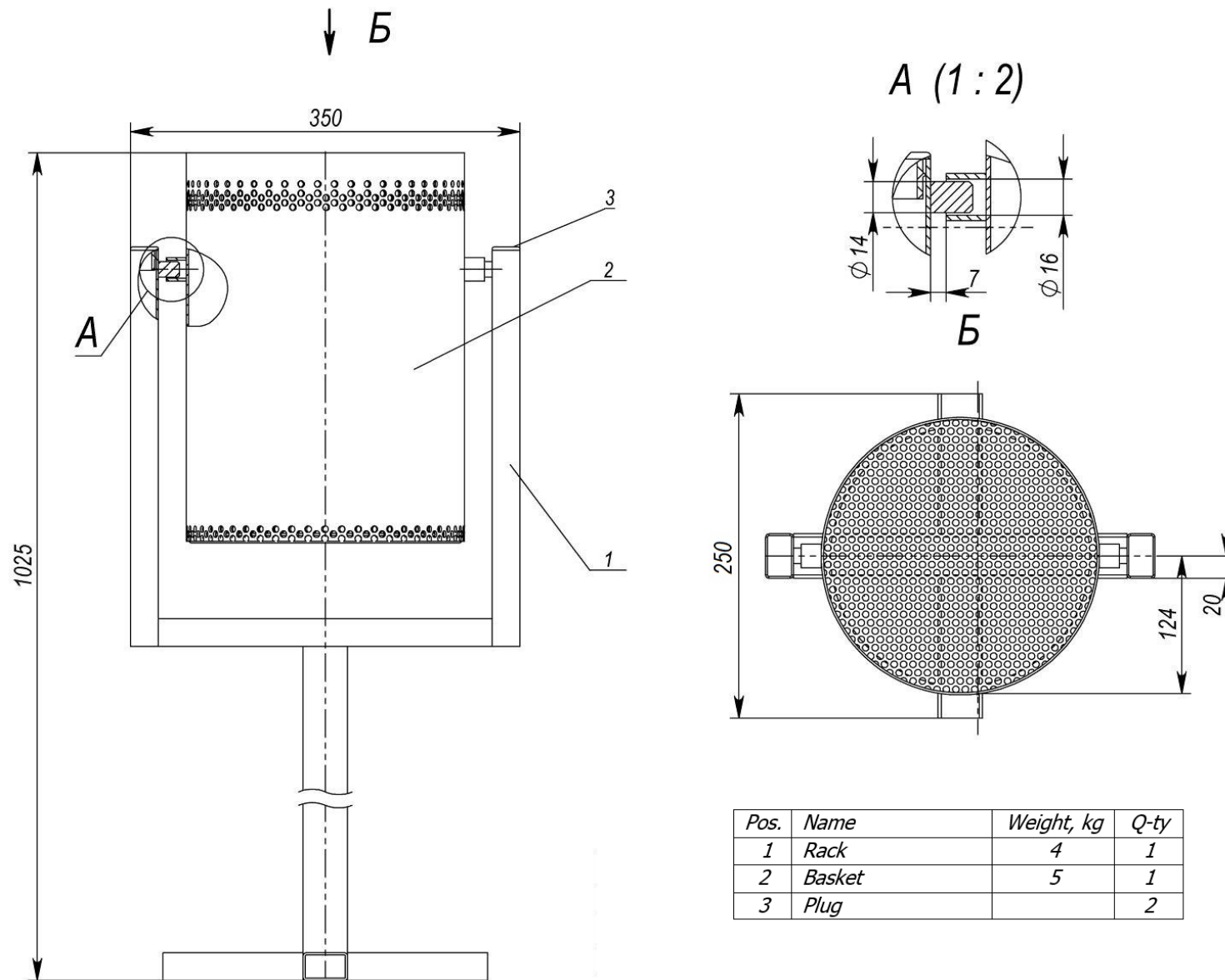

Picture 3 – for S742

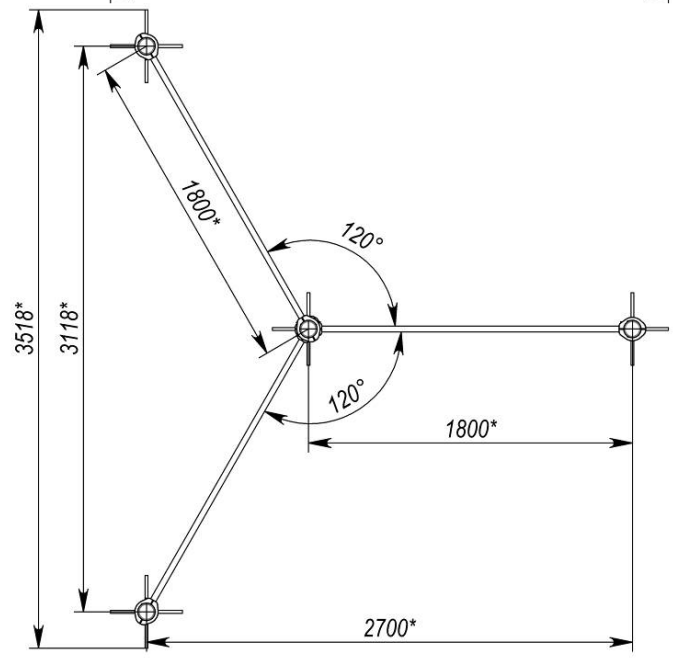
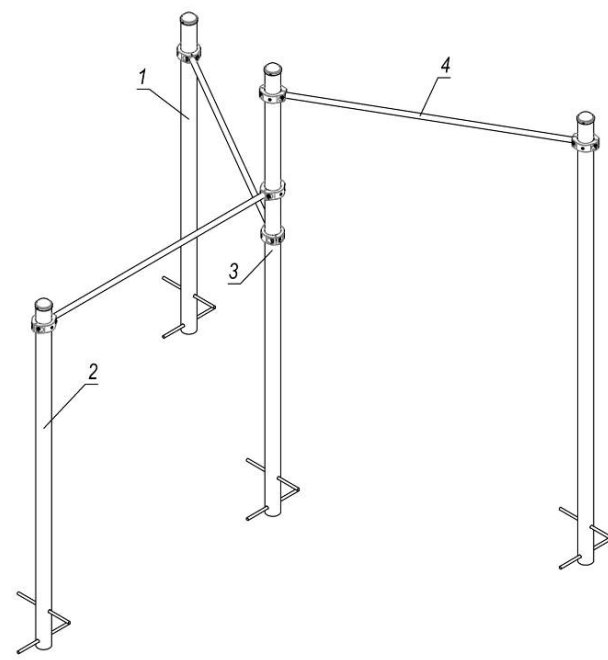
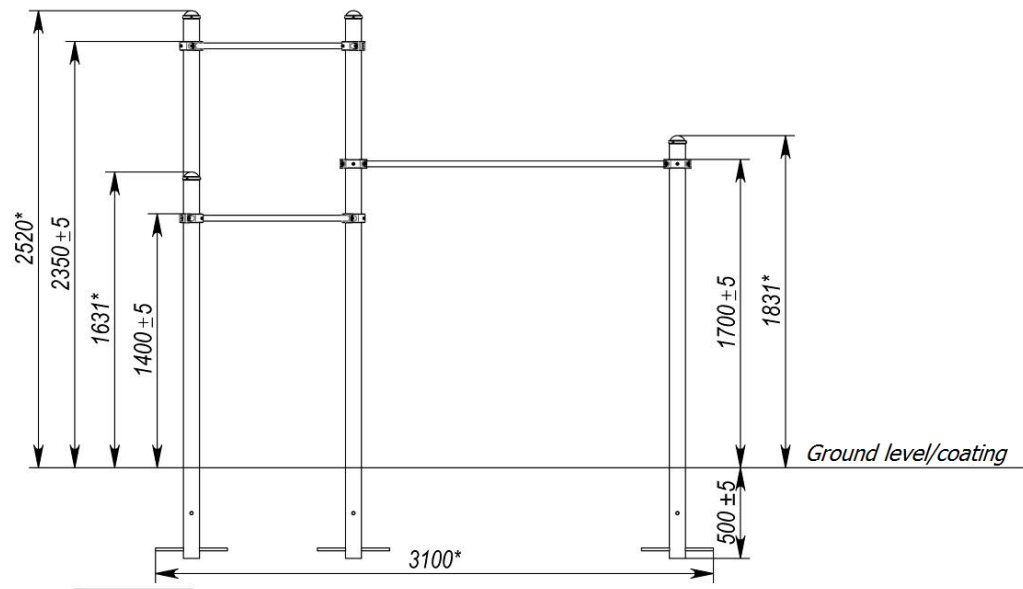

Pos.	Name	Weight, kg	Q-ty
1	Rack 2.1m (L=2113 mm)	19	1
2	Rack 2.3m (L=2334 mm)	21	1
3	Rack 3.0 m	26	2
4	Horizontal bar F32-1.8 m (straight)	6	3

Picture 4 – for S832.6-UA

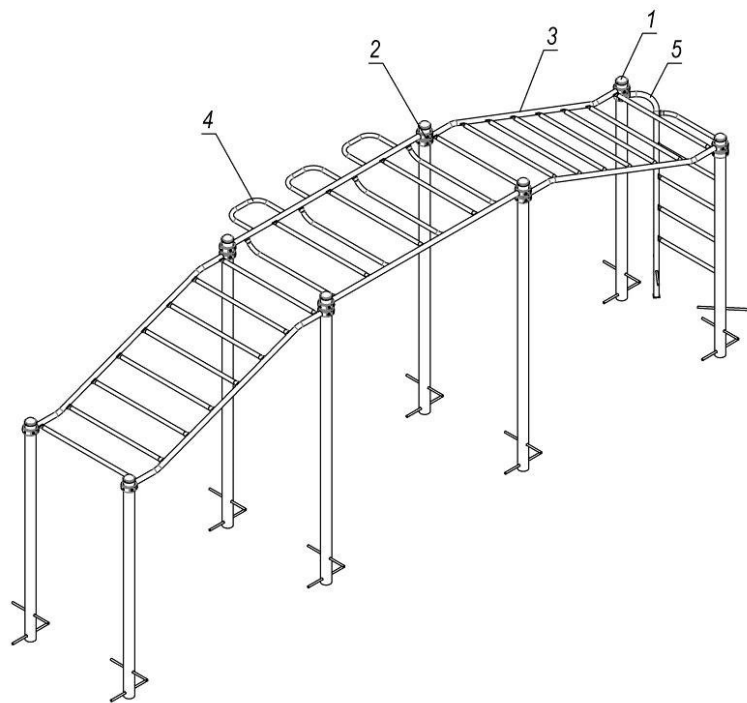
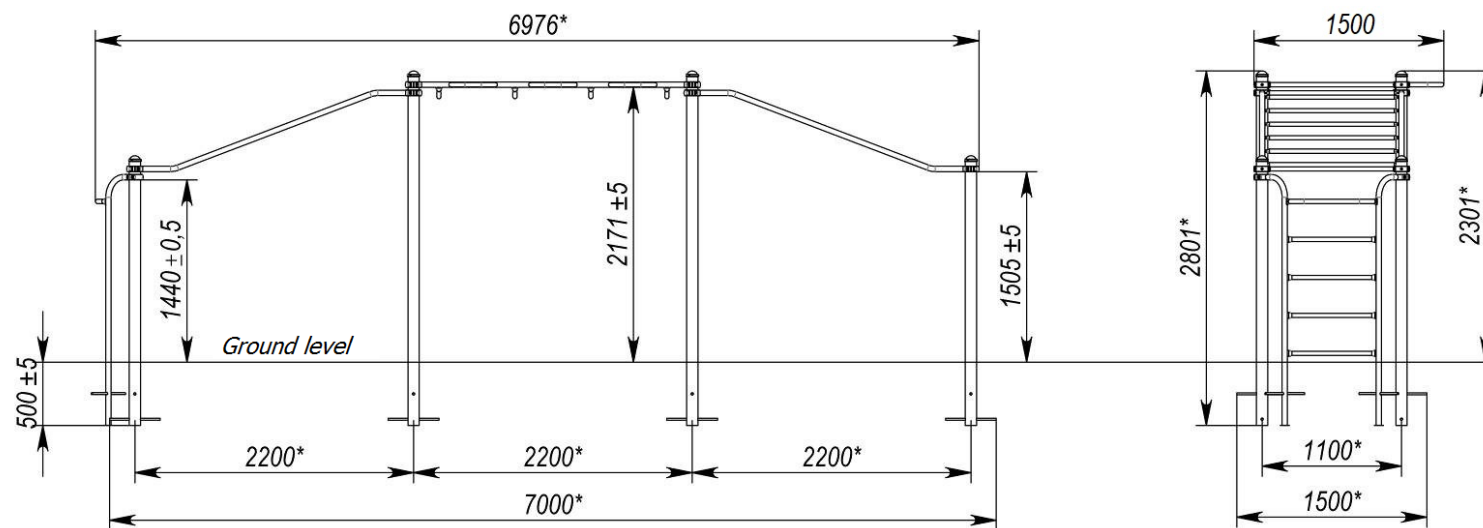

Pos.	Name	Weight, kg	Q-ty
1	Rack 2.1m (L=2113 mm)	19	4
2	Rack 2.8m (L=2804 mm)	25	4
3	Monkey bar 1.1x2.2/0.6 m assembly	37	2
4	Monkey bar 1.1x2.2 m assembly	40	1
5	Ladder assembly	24	1

Picture 5 – for S833.3-UA

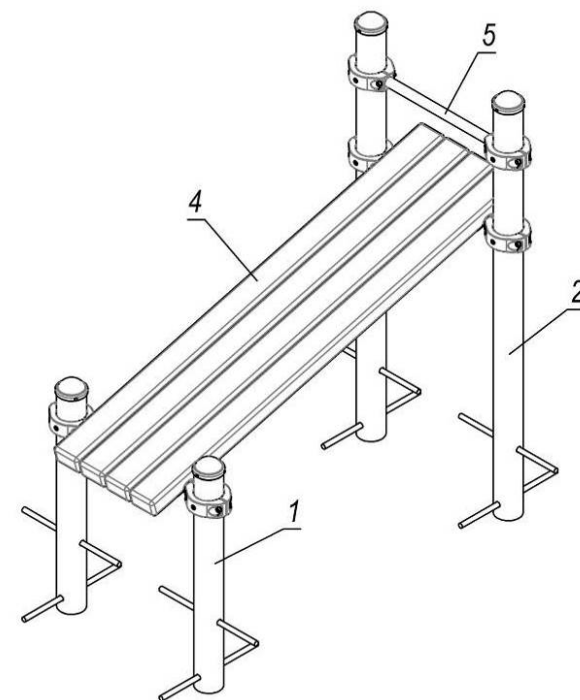
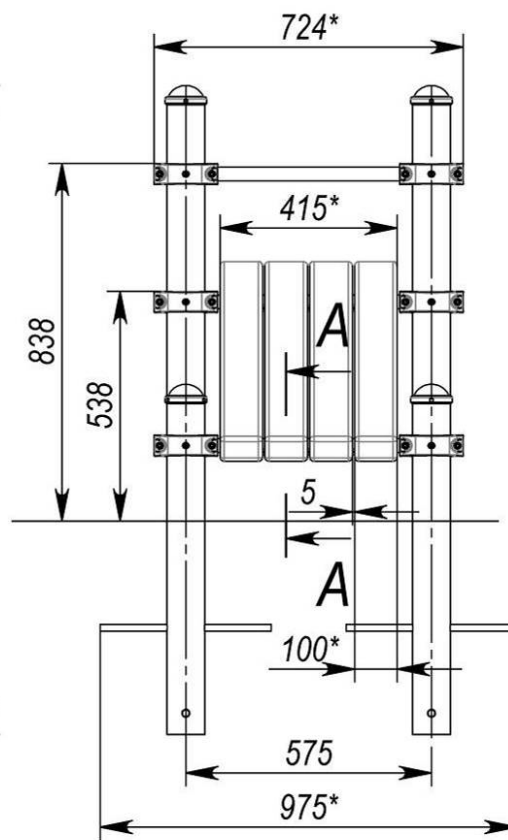
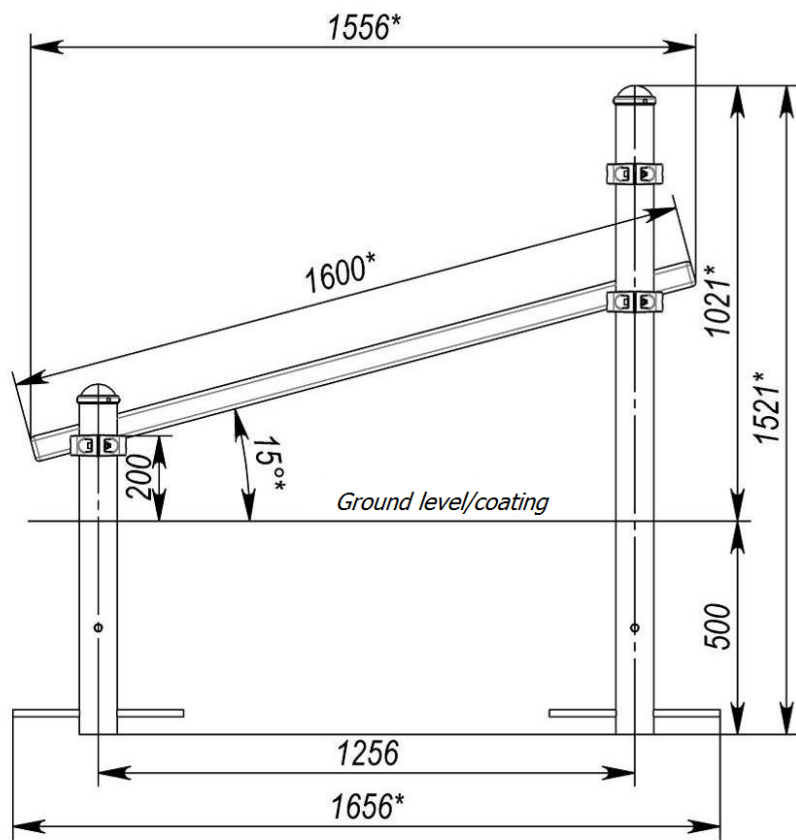

A-A (1 : 5)

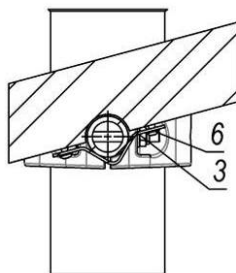

Pos.	Name	Weight, kg	Q-ty
1	Rack 0.8 m	8	2
2	Rack 1.5 m	14	2
3	Clamp		2
4	Crossbar 60*100*1600 mm	6	4
5	Crossbar 575 mm		3
6	Screw 5x50		32

Picture 6 – for S835.4-30

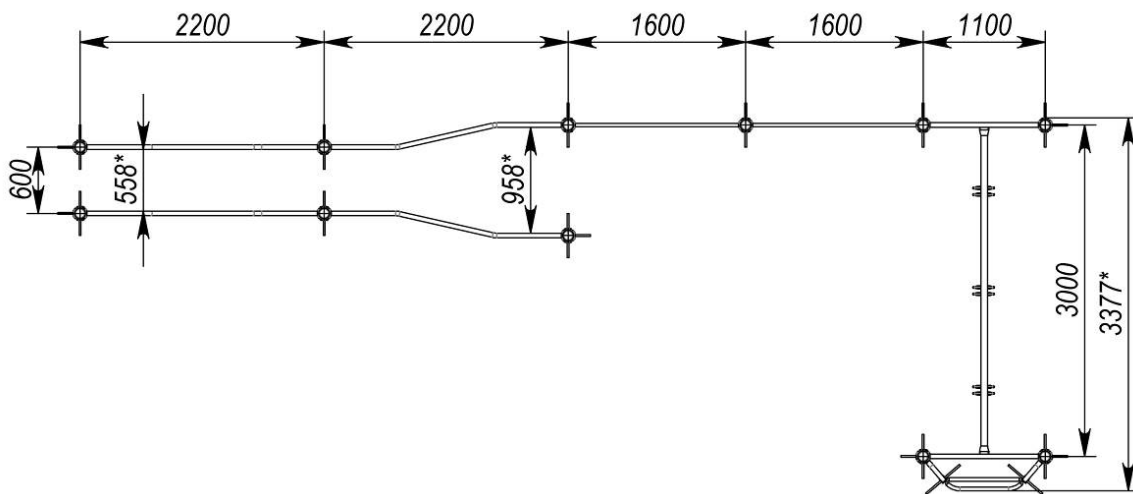
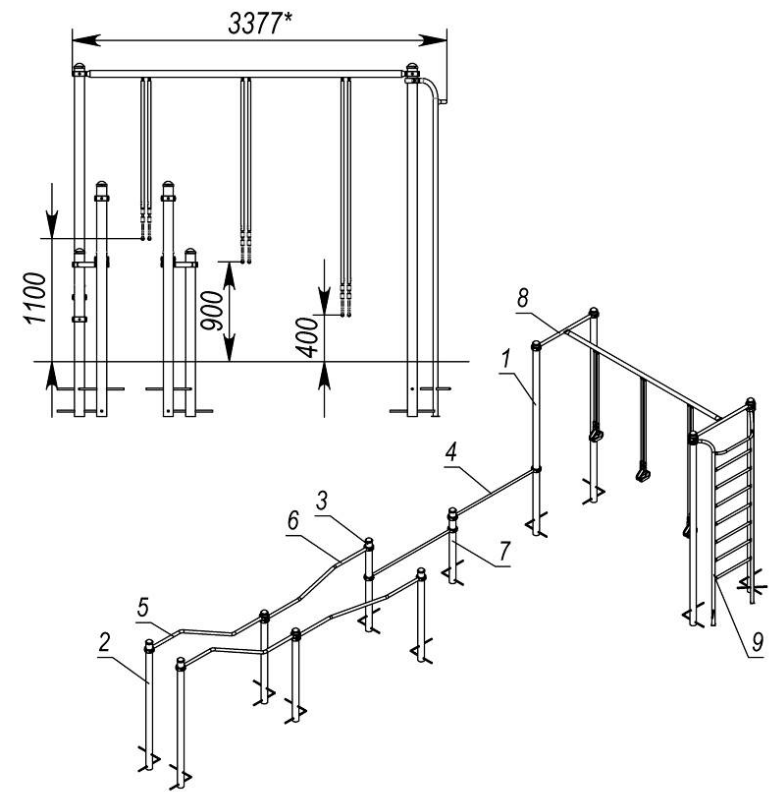
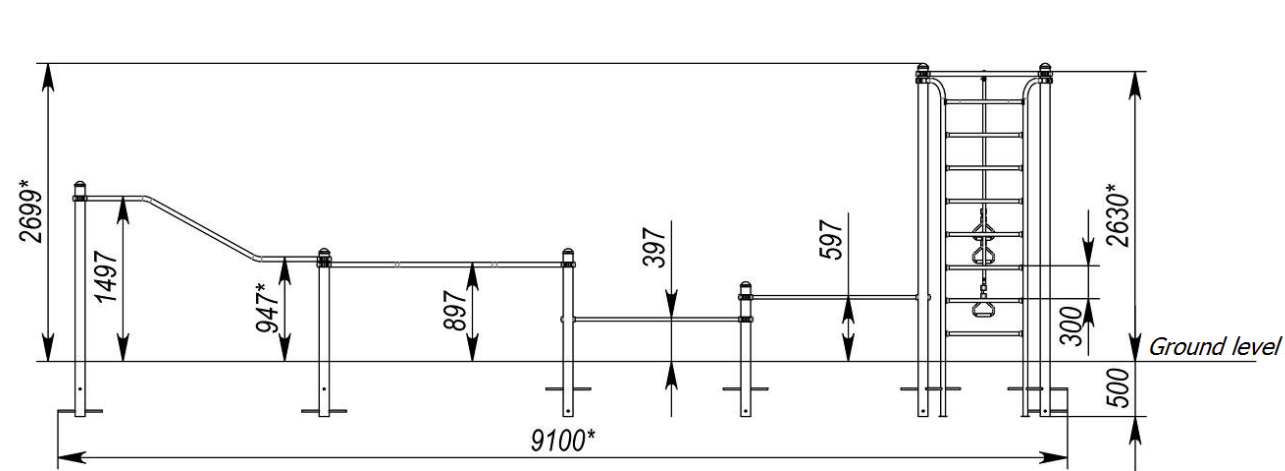

Pos.	Name	Weight, kg	Q-ty
1	Rack 3.2 m assembly	28	4
2	Rack 2.1m (L=2113 mm)	19	2
3	Rack 1.5 m	14	4
4	Horizontal bar F32-1.6 m (straight)	7	2
5	Beam vertical 2.2/0.5 m assembly	9	2
6	Beam horizontal 2.2/0.2 m assembly	9	2
7	Rack 1.2 m	11	1
8	Hoops TRX	40	1
9	Ladder assembly	35	1

Picture 7 – for S836.2-UA

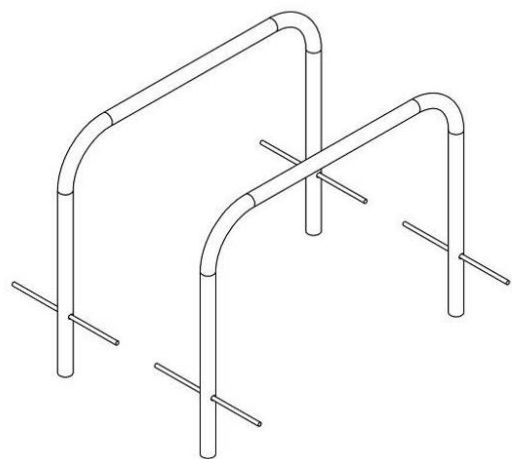
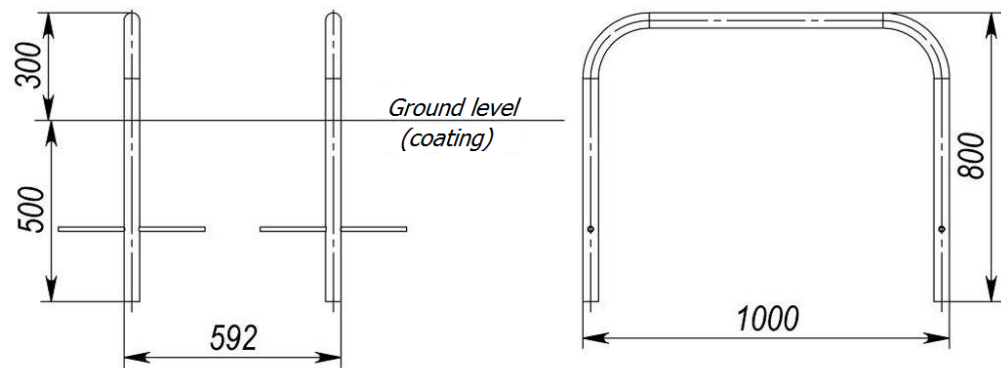

Picture 8 – for S834.7-300-UA

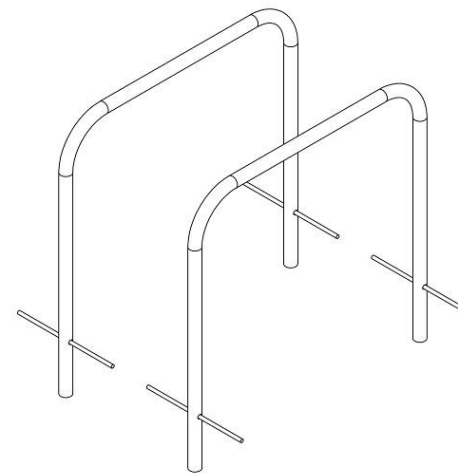
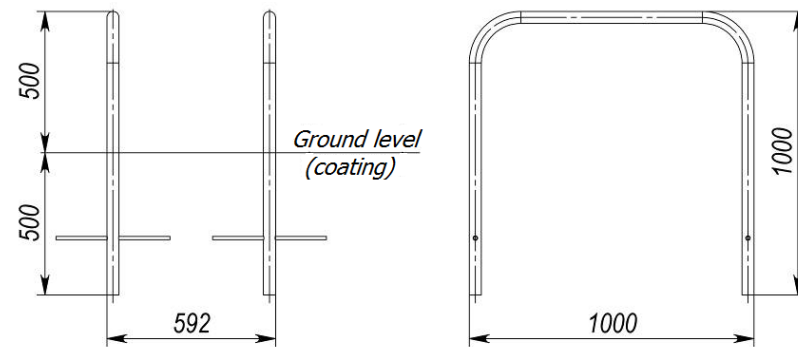

Picture 9 – for S834.7-500-UA

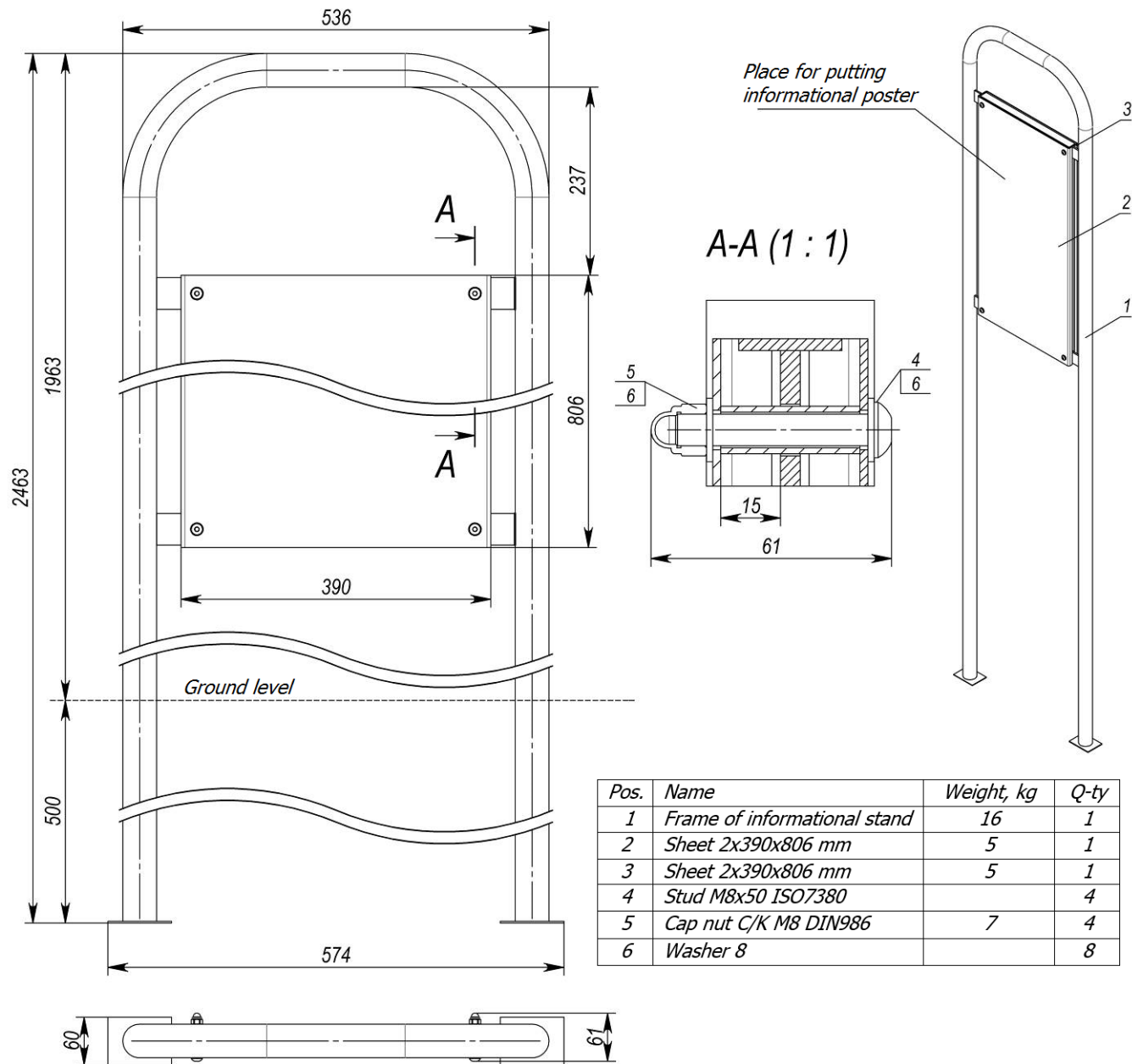

Picture 10 – for SL100-UA